

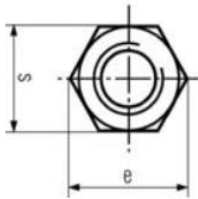

HEX COUPLING NUT

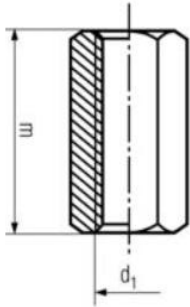

FEATURES AND BENEFITS.

Material:-	Mild Steel, Carbon Steel, Alloy Steel & Stainless Steel.
Standards:-	ASTM/ ASME/ DIN/ BS EN ISO / JIS.
Threads:-	UNC, 8UN, UNF, Metric Coarse and Metric Fine.
Size Range:-	M6 to M64 in Metric series ¼" to 2½" in Imperial Bigger sizes can be manufactured as per order.

* Offering Information :-

- Dimensions – Size.
- Standards and Grade
- Finish (Black, GI, Yellow, HDG, Cadmium, Nickel, PTFE etc)

Product Code	Size (d1) mm	Pitch (mm)	Across Corner (e) mm	Across Flat (S) mm	Length (m) mm
HGEPHCN06	M6	1	11.05	10	18
HGEPHCN08	M8	1.25	14.38	13	24
HGEPHCN10	M10	1.5	18.9	17	30
HGEPHCN12	M12	1.75	21.1	19	36
HGEPHCN14	M14	2	24.49	22	42
HGEPHCN16	M16	2	26.75	24	48
HGEPHCN18	M18	2.5	29.56	27	54
HGEPHCN20	M20	2.5	32.95	30	60
HGEPHCN22	M22	2.5	35.03	32	66
HGEPHCN24	M24	3	39.55	36	72
HGEPHCN27	M27	3	45.2	41	81
HGEPHCN30	M30	3.5	50.85	46	90
HGEPHCN36	M36	4	60.79	55	108

NOTE:- 1. OTHER DIMENSIONS AVAILABLE ON REQUEST.

2. OTHER FINISH ALSO AVAILABLE ON REQUEST.

