

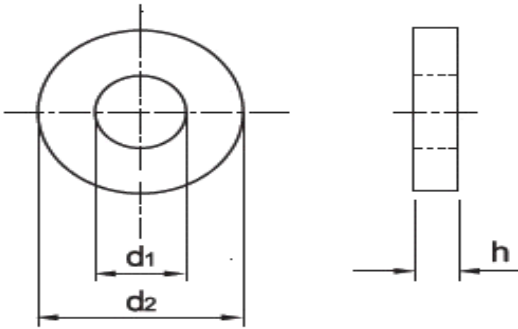

## WASHER (DIN 125/ A)



### FEATURES AND BENEFITS.

|                     |  |
|---------------------|--|
| <b>Material:-</b>   | Mild Steel, Carbon Steel, Alloy Steel & Stainless Steel.   |
| <b>Standards:-</b>  | ASTM/ ASME/ DIN/ BS EN ISO / JIS.  |
| <b>Threads:-</b>    | UNC, 8UN, UNF, Metric Coarse and Metric Fine.  |
| <b>Size Range:-</b> | M6 to M64 in Metric series.<br>¼" to 2½" in Imperial<br>Bigger sizes can be manufactured as per order. |

### \* Typical Grades & Standards :-

- DIN 125/A
- DIN 127/B
- DIN 9021
- ASTM F436 and F436M
- Stainless Steel 304, 304L, 316, 316L, A2-70/ 80, A4-70/ 80

### \* Offering Information :-

- Dimensions – Size.
- Standards and Grade
- Finish (Black, GI, Yellow, HDG, Cadmium, Nickel, PTFE etc)

| Product Code | Size | Inner Diameter (d1)<br>mm | Outer Diameter (d2)<br>mm | Thickness (h) mm |
|--------------|------|---------------------------|---------------------------|------------------|
| HGEPW03      | M3   | 3.2                       | 7                         | 0.5              |
| HGEPW04      | M4   | 4.3                       | 9                         | 0.8              |
| HGEPW05      | M5   | 5.3                       | 11                        | 1                |
| HGEPW06      | M6   | 6.4                       | 12                        | 1.6              |
| HGEPW08      | M8   | 8.4                       | 16                        | 1.6              |
| HGEPW10      | M10  | 10.5                      | 20                        | 2                |
| HGEPW12      | M12  | 13                        | 24                        | 2.5              |
| HGEPW14      | M14  | 15                        | 28                        | 2.5              |
| HGEPW16      | M16  | 17                        | 30                        | 3                |
| HGEPW18      | M18  | 19                        | 34                        | 3                |
| HGEPW20      | M20  | 21                        | 37                        | 3                |
| HGEPW22      | M22  | 23                        | 39                        | 3                |
| HGEPW24      | M24  | 25                        | 44                        | 4                |
| HGEPW27      | M27  | 28                        | 50                        | 4                |
| HGEPW30      | M30  | 31                        | 56                        | 4                |
| HGEPW33      | M33  | 34                        | 60                        | 5                |
| HGEPW36      | M36  | 37                        | 66                        | 5                |
| HGEPW39      | M39  | 40                        | 72                        | 6                |
| HGEPW42      | M42  | 43                        | 78                        | 7                |
| HGEPW45      | M45  | 46                        | 85                        | 7                |
| HGEPW48      | M48  | 50                        | 92                        | 8                |
| HGEPW52      | M52  | 54                        | 98                        | 8                |
| HGEPW56      | M56  | 58                        | 105                       | 9                |
| HGEPW64      | M64  | 66                        | 115                       | 9                |
| HGEPW72      | M72  | 74                        | 125                       | 10               |

**NOTE:-** 1. OTHER DIMENSIONS AVAILABLE ON REQUEST.  
2. OTHER FINISH ALSO AVAILABLE ON REQUEST.

