

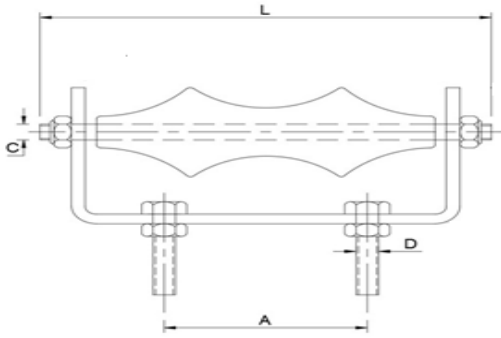

ROLLER CHAIR



FEATURES AND BENEFITS.

Description:-	* For support of pipe where horizontal movement due to expansion and contraction may occur.
Material:-	Bracket : Mild Steel Roller : MILD STEEL / CAST IRON
Special:-	* Electro galvanized as per ASTM B 633. * Galvanized as per ASTM A 123 / A 123M. * Designed to meet MSS Standard SP-58-2002, type 44 and SP-69.

Product Code	Nominal Pipe Size		Pipe OD (D) mm	Dimensions (mm)			Max Load (N)
	In.	mm		A	CXL	D	
HGEPRC034	1"	DN25	33.4	20	M10 x 90	M12 x 50	4000
HGEPRC060	2"	DN50	60.3	35	M12 x 115	M12 x 50	6700
HGEPRC073	2 ½"	DN65	73	35	M12 x 125	M12 x 50	10000
HGEPRC090	3"	DN80	88.9	50	M12 x 145	M12 x 50	13800
HGEPRC101	3 ½"	DN90	101.6	50	M12 x 160	M12 x 50	17300
HGEPRC114	4"	DN100	114.3	50	M12 x 175	M16 X 75	21100
HGEPRC141	5"	DN125	141.3	75	M12 x 200	M16 X 75	30400
HGEPRC168	6"	DN150	168.3	80	M20 x 245	M16 X 75	34700
HGEPRC219	8"	DN200	219.1	85	M24 x 305	M20 X 100	34700
HGEPRC273	10"	DN250	273	130	M24 x 365	M20 X 100	42900
HGEPAR323	12"	DN300	323.8	140	M24 x 425	M20 X 100	53400
HGEPRC356	14"	DN350	355.6	165	M24 x 460	M24 X 100	53400
HGEPRC406	16"	DN400	406.4	210	M24 x 515	M24 X 100	53400
HGEPRC457	18"	DN450	457.2	235	M33 x 580	M24 X 100	62300
HGEPRC508	20"	DN500	508.2	260	M33 x 630	M24 X 100	71100
HGEPRC610	24"	DN600	609.6	310	M52 x 780	M24 X 100	71100
HGEPRC661	26"	DN650	661	335	M52 x 845	M24 X 100	76000
HGEPRC712	28"	DN700	712	360	M52 x 895	M24 X 100	76000
HGEPRC755	30"	DN750	755	385	M52 x 940	M24 X 100	80000

NOTE:- 1. CUSTOMIZED DIMENSIONS AVAILABLE ON REQUEST.

2. a. EP - MICRONS : 8μ - 15μ.

b. HDG - MICRONS : 70μ - 95μ.

